

March 2021

Being Published Since 2005

[www.mgsarchitecture.in](http://www.mgsarchitecture.in)

Total Pages 54 Including Cover

₹150/-

Vol. 8 Issue 12

# MGS Modern Green Structures & Architecture

An NBM Media Group Publication

+ Interior Design

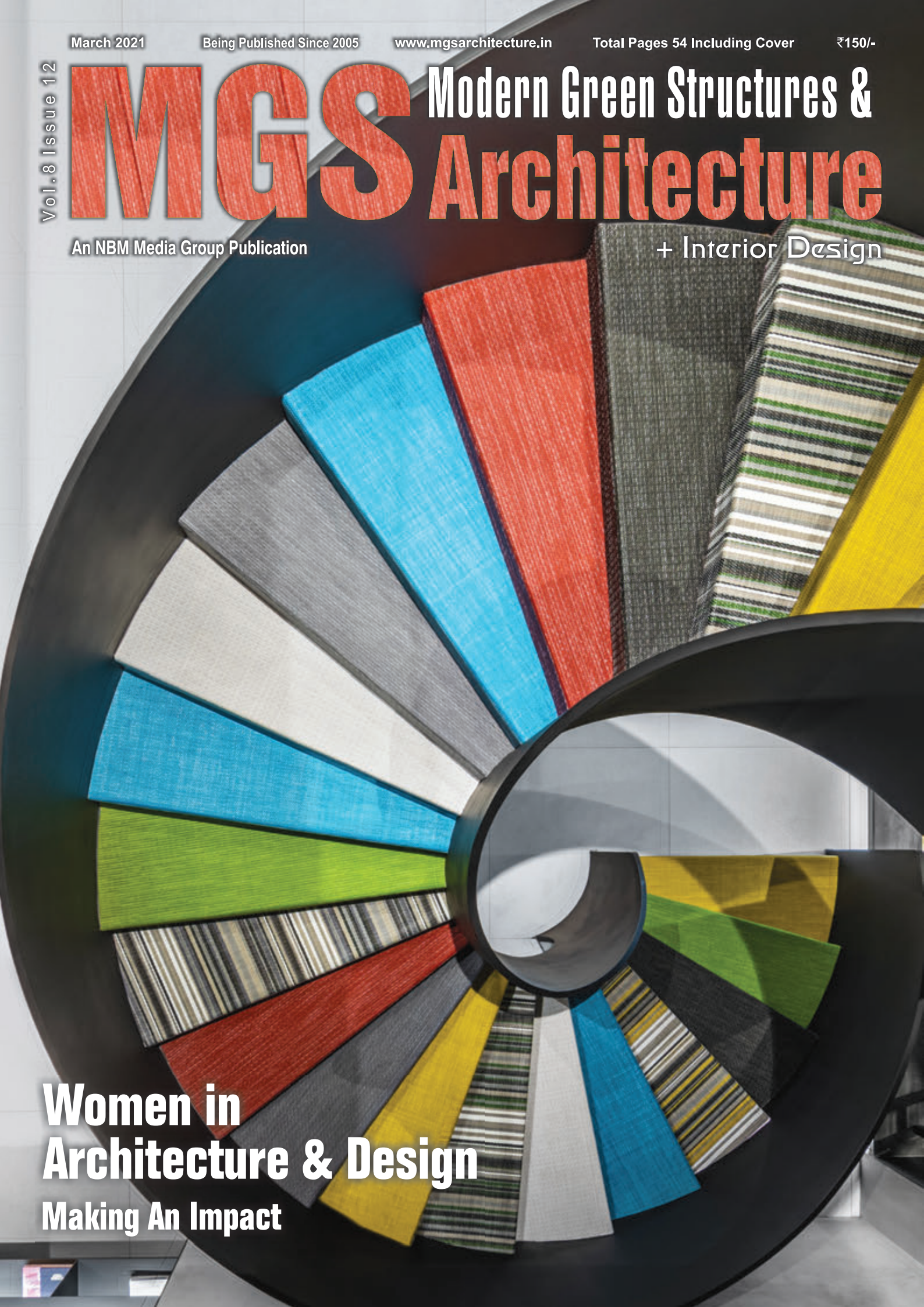

**Women in  
Architecture & Design**  
Making An Impact

# Contents

MARCH 2021



## Façade

- 10 Ar. Harish Gupta, Habitat n Skins, writes on the acoustic design considerations of the facade
- 12 MVRDV completes second Bvlgari façade at flagship store in Bangkok
- 14 2,000 custom-fit motorized shades of Altex enhance the architectural design of Deloitte Summit Tower

## Special Feature

### Women in Architecture & Design

- 16 We bring to you 15 achievers who share snippets of their professional journey and dole out some advice to like-minded, would-be achievers

## Architecture & Design

- 34 Studio: 9Studio Design Group has designed their studio like the setting for a science fiction movie
- 38 Restaurant: Batay-Csorba Architects (BCA) has designed a non-traditional restaurant as a place to connect people yet giving them their own personal space

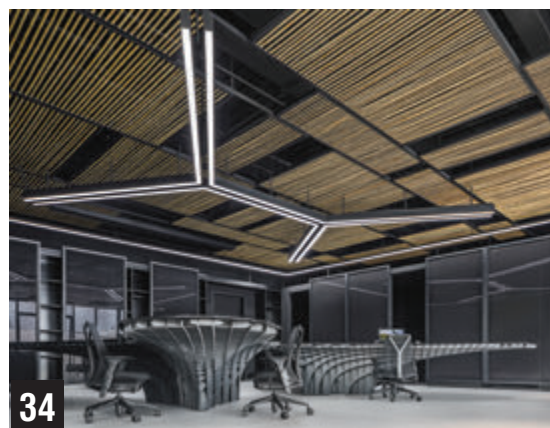

# Contents



- 40 Apartment: For l'atelier, Nomadic Architecture Studio, the project required converting an old 50 sqm 1-bedroom apartment into a home for a family of five
- 42 Residence: In its design, Prateek Gupta Architects aims to create an organic connection with the microclimate
- 46 Weekend House: Studio PKA's design responds, adapts and lives in harmony with the five elements of Nature



## Newstrack

- 50 Colliers International India delivers Microsoft's newest IDC hub in Noida
- 52 Virasat Interiors is offering eco-friendly and durable interlocked tiles
- 52 AEC design tech firm FivD collaborates with HKS



Cover courtesy:  
9Studio Design Group

**Head Office: NBM Media Pvt. Ltd.**

B-27, IInd Floor, Nizamuddin West, New Delhi-110 013

Ph: +91-11-26832424, +91-98181 65648, 79829 31374

E-mail: info@nbmcw.com, www.mgsarchitecture.in

**Group Managing Editor**

S. A. Faridi

**Editorial**

Maria R – Editor

Seema Gupta\* – Executive Editor

P. C. Sharma – Chief Editor

Jeet Singh – Associate Editor

Rana F. – Assistant Editor

S. K. Khanna – Senior Correspondent

Varsha Trehan – Special Correspondent

**Marketing**

S.K. Rizvi – Business Head

M. +91-98109-19797

E-mail: marketing@nbmcw.com

**Mumbai**

Neelkanth Menon, M. +91-98202-45763

E-mail: nkm@nbmcw.com

Satya Pathak, M. +91-91361-34509

E-mail: satya@nbmcw.com

**Gujarat**

Krishnakant Panchal, M. +91-98982-22244

E-mail: panchal@nbmcw.com

**Circulation**

Geetika – Manager Circulation

Shaifar K.

**Production**

S. Sheikh – Publishing Manager

Rajesh Mishra – Manager Production

Najam Khan – Studio Head

Azhar Abbas Abbasi – Head - IT

**Managing Director & Publisher**

M. A. Faridi

## Subscription ₹1800 / One Year

All payments in favor of **NBM Media Pvt. Ltd.** New Delhi. **No part of this publication may be reproduced by any means without prior written permission from Editor.**

\* Responsible for selection of news under the PRB Act.

**MGS - Modern Green Structures & Architecture** is not responsible for statements made, or for opinions expressed, in the articles published in this volume and publisher accepts no responsibility for accuracy of information, errors or omissions and rejects any claims arising out of any action which a company or individual may take on the basis of information contained herein.

**MGS - Modern Green Structures & Architecture** is Printed and published by S.A. Faridi, on behalf of NBM Media Pvt. Ltd., and printed at Samrat Offset Pvt. Ltd., B-88, Okhla Ind. Area, Phase-II, New Delhi-110020 and published at B-27, 2<sup>nd</sup> Floor, Nizamuddin (West) New Delhi-110013. Editor S.A.Faridi. All Rights Reserved. Copyright © 2011 NBM Media Pvt. Ltd.

## Where the Elements Meet

**Studio PKA designs a weekend retreat that responds, adapts and lives in harmony with the five elements of Nature**

**P**avana, landlocked by the Sahyadris and guarded by three forts, is famous for its pristine landscape, and fast becoming a tourist hotspot. Snaking its way up a steep slope riddled with hairpin bends that overlook the range, the site overlooks a shimmering lake - a man-made marvel contained by a towering dam. The house on top of the hill, reminiscent of the forts in the horizon, revels in its ability to become one with the land it stands on.

The house rises and falls, following the lay of the land. Each level responds to the contour which gives rise to a dynamic and playful mix of risers and landings. Following the profile of the roofs, large fenestrations bring in daylight and warmth. The textured and subdued wintergreen walls mimic the tones of earth.





The footprint ensures that the site has been altered to a bare minimum. The very form of the design tries to embrace the landscape, creating multiple vantage points from within - making it easy to forget where the house ends and the outside begins. Spaces were imagined to develop and narrate their own story over time – in sync with the natural environment





View of the Guest Block



Inside - Outside Connect



The Living Block

A simple and earthy palette of materials and tones – limestone (Shahabad & Kadappa), sandstone, slate, teak wood, terracotta tiles, exposed brick, cement plaster, and mild steel, complement the natural surroundings. The design evolved from a cohesive single unit to a structure that spreads out in blocks, with built and unbuilt spaces interlocking to create a whole. The unbuilt open spaces act as natural extensions that exist as distinct entities which seamlessly merge to convey the duality of space. As the extensions branch out in the form of bridges, the disparate blocks come together, effectively eliminating the sense of distance.

The very form of the design tries to embrace the landscape, creating multiple vantage points from within. Segregated into numerous zones – the master block, the kids block, the living block and the guest block. Each zone spills out into an informal space the angan (small courtyard), the pool, the lily pond – that ensure the continuity and flow of spaces from the interior to the exterior. An edgeless cantilevered swimming pool juts out towards the crystalline lake. As a direct response to the site – the altitude and the prevailing climatic conditions – currents of wind are allowed to flow through the numerous openings and are directed along the two main axes of the site.

**Fact File**

Project name: 5 Element House

Location: Pavana, Maharashtra

Site Area: 9 acres

Gross Area: 10,000 sq.ft

Principal Architect: Puran Kumar

Design team: Preethi Krishnan, Sonali Nimbalkar, Revina Soni

Image Credits: Amit Pasricha



View of the Master Block

